

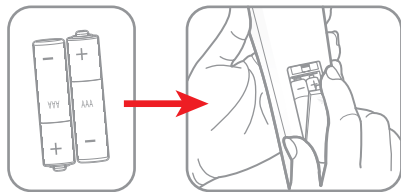

如需了解详细的设置说明，请扫描二维码或访问以下 URL：
<https://www.optoma.com/support/download>

1

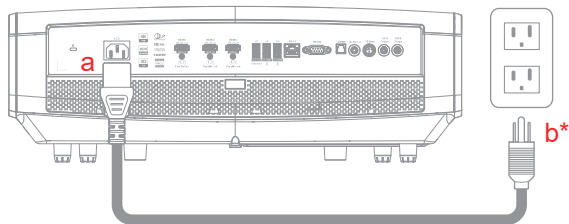

2

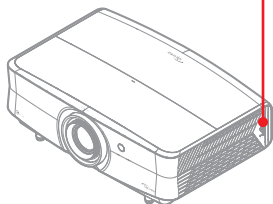
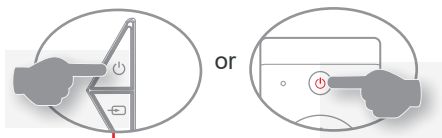

3

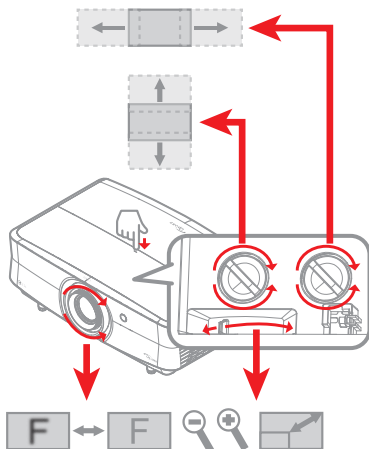

4

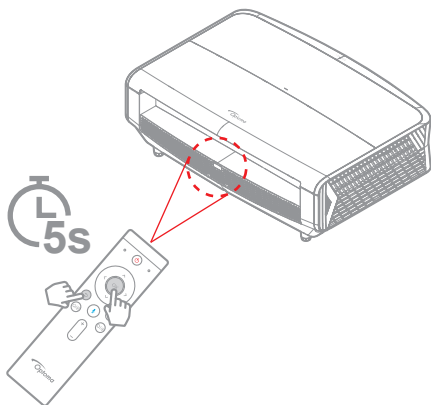

5

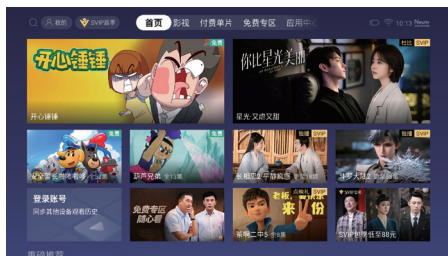

注意：腾讯极光视频内容请以实际画面为准，此画面仅供参考。

注意：开箱设置期间，会执行配对过程。同时长按OK和 \square 按钮5秒钟可将蓝牙遥控器与投影机配对。

6

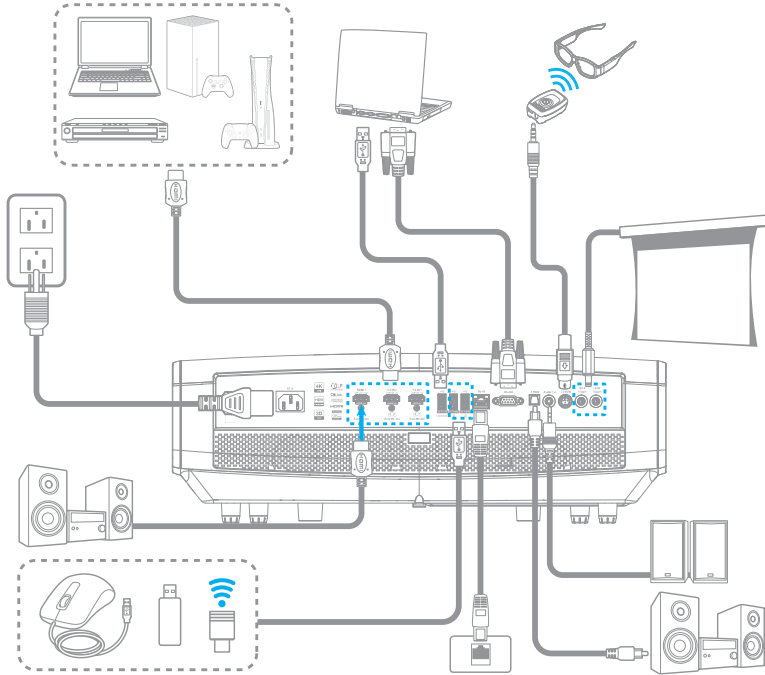

7



注意：

- 有关保修信息，请访问我们的网站：www.optoma.com
- 如需获取更多信息 -- 请扫描二维码或访问以下 URL：<https://www.optoma.com/support/download>

Safety information

- Before operating the projector it is essential to read the full safety information in the user manual.
- Do not look into the projector lens during operation. The bright light may harm your eyes.
- Do not block projector inlet or outlet air vents. Do not place the projector on an unstable surface as it may damage the projector or injure the personnel.
- Only use attachments/accessories specified by the manufacturer.
- Do not let objects or liquids enter the projector as it may cause the fire or electric shock.
- To reduce the risk of fire or electric shock, do not expose this appliance to rain or moisture.
- Make sure that the operating environment meets the requirements in the user manual.
- Do not install near heat sources such as radiators, heaters, stoves or any other apparatus such as amplifiers that emits heat.
- Please do not open or disassemble the projector as this may cause electric shock. The unit should only be repaired by authorized service personnel.
- Turn off the projector and unplug the power cord before you maintain the projector.
- *Use a power strip and or surge protector. As power outages and brown-outs can KILL devices.

Note:

- This pairing process phase occurs during the out of box setup. When prompted (onscreen), hold the Bluetooth remote control 3 to 5 inches from the Bluetooth receiver at the rear of the projector. Then long press the **OK** and **↵** buttons simultaneously for 5 seconds to pair the Bluetooth remote control with the projector.
- If the remote control is not paired via Bluetooth during the unboxing setup, you can go to the home screen, open Bluetooth settings, and press the combination keys to pair the remote control with the projector via Bluetooth.
- For warranty information, please visit our website: www.optoma.com

安全信息

- 操作投影机之前，务必详细阅读本手册中的安全信息。
- 请勿在运行期间注视投影机镜头。亮光可能会伤害您的眼睛。
- 请勿堵塞任何通风口。不要将投影机放置在不稳定的表面上。否则，投影机可能会受损或导致人员受伤。
- 仅使用制造商指定的连接件/附件。
- 不要让物品或液体进入投影机。否则，它们可能导致火灾或电击。
- 为降低火灾和触电危险，切勿使本投影机遭受雨淋或受潮。
- 确保操作环境符合操作手册中的要求。
- 不要安装在热源附近，如散热器、加热器、火炉或其它产生热量的设备（如放大器）。
- 请勿打开或拆卸投影机，否则可能会导致触电，应由授权的维修人员进行维修。
- 在维护、安装投影机之前，应先关闭投影机并拔掉电源线。
- *使用电源线和或电涌保护器。断电和电压低会造成设备损坏。

注意：

- 此配对过程发生在开箱设置期间。（屏幕上）出现提示时，使蓝牙遥控器距离投影机尾部的蓝牙接收器 3 到 5 英寸。同时长按 **OK** 和 **↵** 按钮 5 秒钟可将蓝牙遥控器与投影机配对。
- 若在开箱设置期间没有进行遥控器蓝牙配对，可在进入 Home 信号源后，打开蓝牙设置，可继续按组合键使遥控器与投影机进行蓝牙配对。
- 关于保修信息，请访问我们的网站：www.optoma.com



P/N:36.7N711G001-A