

PHILIPS

Internet Radio

TAPR802

Quick Start Guide



Register your product and get support at
www.philips.com/support



- EN** Before using your product, read all accompanying safety information
- CS** Před použitím produktu si přečtěte doprovodné bezpečnostní informace
- DA** Læs alle medfølgende sikkerhedsoplysninger; inden du tager produktet i brug
- DE** Lesen Sie vor Verwendung dieses Produkts alle begleitenden Sicherheitsinformationen
- EL** Πριν χρησιμοποιήσετε το προϊόν, διαβάστε όλες τις παρεχόμενες πληροφορίες ασφάλειας
- ES** Antes de usar el producto, lea toda la información de seguridad adjunta
- FI** Lue kaikki turvallisuustiedot ennen tuotteen käyttöä
- FR** Avant d'utiliser votre produit, lisez l'intégralité des consignes de sécurité jointes
- HU** A termék használatá előtt alaposan olvassa el a mellékelt biztonsági tudnivalókat
- IT** Prima di utilizzare il prodotto, leggere tutte le relative informazioni sulla sicurezza
- NL** Lees voordat u het product gaat gebruiken eerst alle bijbehorende veiligheidsinformatie
- NO** Les all vedlagt sikkerhetsinformasjon før du bruker produktet
- PL** Przed rozpoczęciem korzystania z produktu należy zapoznać się z informacjami dotyczącymi bezpieczeństwa
- PT** Antes de utilizar o produto, leia todas as informações de segurança que o acompanham
- RO** Înainte de a utiliza acest produs, citiți toate informațiile de siguranță care îl însoțesc
- SK** Pred použitím produktu si prečítajte všetky sprievodné bezpečnostné informácie maklumat keselamatan yang disertakan
- SV** Innan du använder produkten ska du läsa all tillhörande säkerhetsinformation
- TR** Ürününüzü kullanmadan önce ilgili tüm güvenlik bilgilerini okuyun
- RU** Перед использованием устройства ознакомьтесь со всеми прилагаемыми инструкциями по безопасности
- UK** Перед використанням пристрою прочитайте усю інформацію з техніки безпеки, що додається
- KK** Өнімді пайдаланбастан бұрын, барлық қосымша қауіпсіздік ақпаратын оқыңыз
- AR** قبل استخدام المنتج الخاص بك ، اقرأ جميع معلومات السلامة المصاحبة

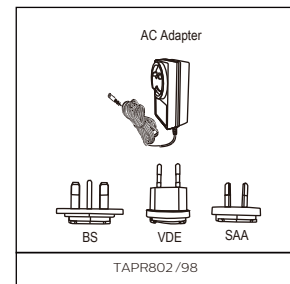
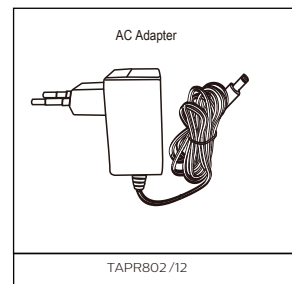
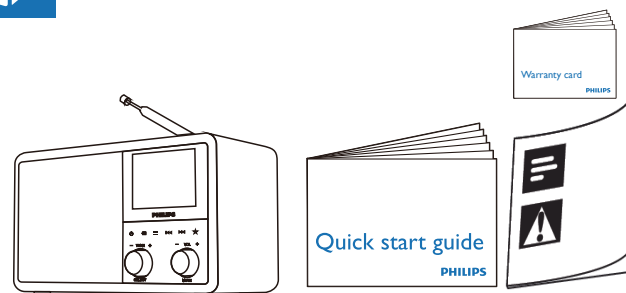



1



1

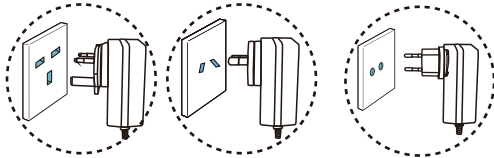
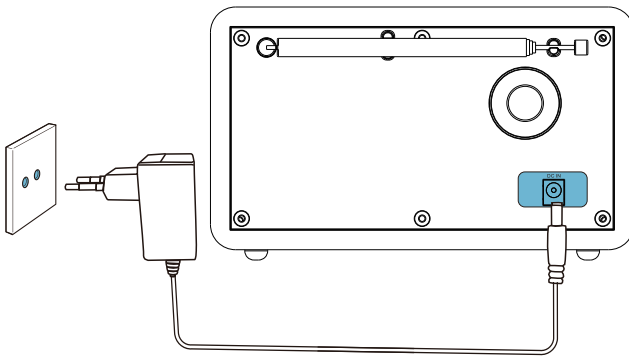

2

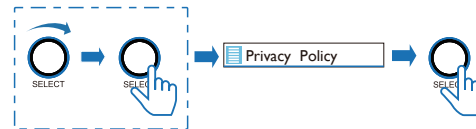
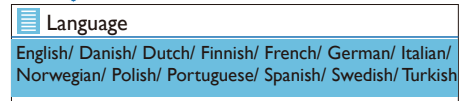
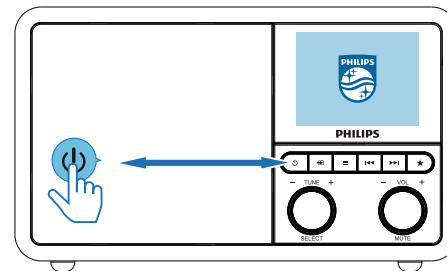

2

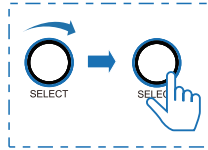
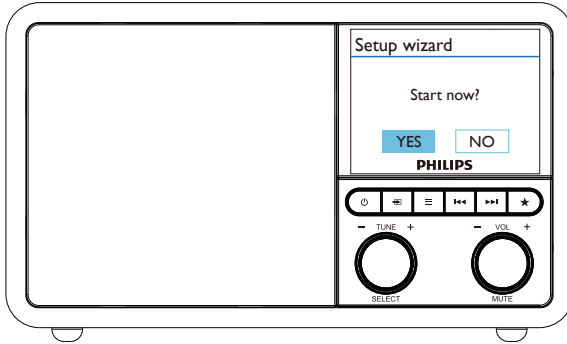

- 1 **Date/Time**
12/24 hour format
- 2 **Auto update**
update from DAB
update from FM
update from Network *
No update
- 3 **Set timezone**
UTC +00:00:Dublin, Lc...*
UTC +00:30:
UTC +01:00: Madrid, An...
UTC +01:30:
UTC +02:00: Athens, Ca...
- 4 **Daylight savings**
Daylight savings
- 5 **Network settings**
Keep network conneted?
- 6 **Network settings**
Network wizard
Scanning \
- 7 **SSID**
18028591840
360M1_TEST
360WiFi
AndroidAP-I40C
BMW-087C
- 8 **Key:**
0 1 2 3 4 5 6 B K S P
7 8 9 . _ - @ OK
, a b c d e CANCEL
f g h i j k l
m n o p q r s
- 9 **Network settings**
Please wait
connecting \
- 10 **Connected**



3

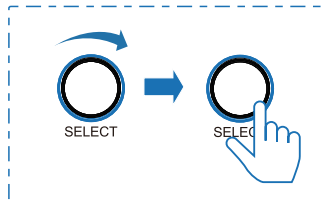
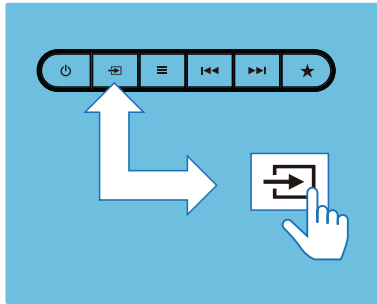



4

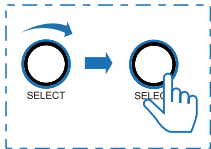

Main menu

- Internet radio**
- Podcasts
- Spotify
- DAB
- FM
- Bluetooth
- Sleep
- Alarms
- System settings >

Internet radio

Please wait loading \

Internet radio

- China** >
- History >
- Search >
- Location >
- Popular >



Internet radio

- Station list** >
- System settings >
- Main menu >

Main menu

- Internet radio
- Podcasts**
- Spotify
- DAB
- FM
- Bluetooth
- Sleep
- Alarms
- System settings >

Podcasts

Please wait loading \

Podcasts

- China** >
- Search >
- Popular >
- Location >
- Discover >



Podcasts

- Podcast list** >
- System settings >
- Main menu >

Main menu

- Internet radio
- Podcasts
- Spotify**
- DAB
- FM
- Bluetooth
- Sleep
- Alarms
- System settings >

Spotify

Spotify. Go to spotify.com/



Spotify

- System settings** >
- Main menu >



5

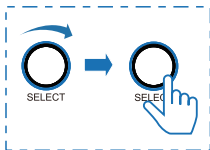

Main menu

- Internet radio
- Podcasts
- Spotify
- DAB**
- FM
- Bluetooth
- Sleep
- Alarms
- System settings >

Scan

Stations: 10
Scanning

Station list

- 2DAY**
- 2SM 1269
- 2UE News Talk
- FAB-4
- GORILLA



DAB

- Station list >**
- Scan
- Manual tune >
- Prune invalid >
- DRC >

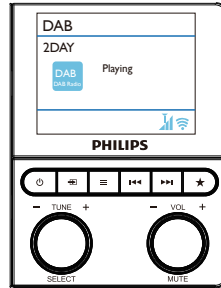

Save to preset

- [Not set]
- [Not set]
- [Not set]
- [Not set]
- [Not set]



Preset stored



Recall from preset

- 2DAY**
- [Not set]
- [Not set]
- [Not set]
- [Not set]



6

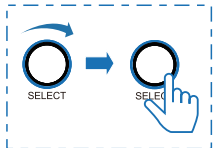

- Main menu
 - Internet radio
 - Podcasts
 - Spotify
 - DAB
 - FM**
 - Bluetooth
 - Sleep
 - Alarms
 - System settings >

- FM
 - Scan setting**
 - Audio setting >
 - System settings >
 - Main menu >

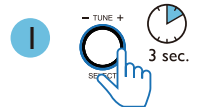
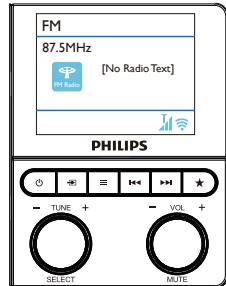

Auto search 87.5MHz-108MHz → Auto saving(20)



- Recall from preset
 - 88.00MHz
 - 88.30MHz
 - 89.30MHz
 - 90.60MHz
 - 91.40MHz



- Save to preset
 - 88.00MHz
 - 88.30MHz
 - 89.30MHz
 - 90.60MHz
 - 91.40MHz



- Recall from preset
 - 87.5MHz
 - 88.30MHz
 - 89.30MHz
 - 90.60MHz
 - 91.40MHz

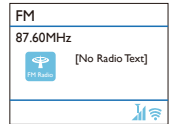

- Save to preset
 - 87.5MHz
 - 88.30MHz
 - 89.30MHz
 - 90.60MHz
 - 91.40MHz

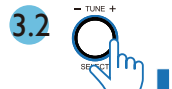

- Recall from preset
 - 87.60MHz
 - 88.30MHz
 - 89.30MHz
 - 90.60MHz
 - 91.40MHz



7

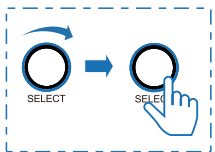

- Main menu
- Internet radio
- Podcasts
- Spotify
- DAB
- FM
- Bluetooth**
- Sleep
- Alarms
- System settings >

- Bluetooth
- [No media]

- Bluetooth
- Pair >
- View details >
- System settings >
- Main menu >

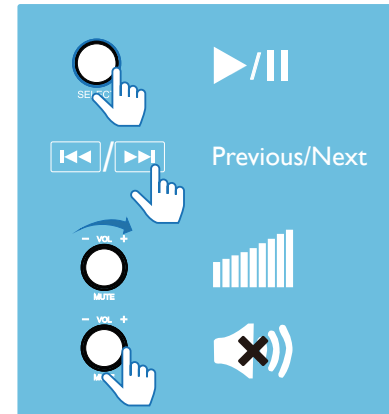
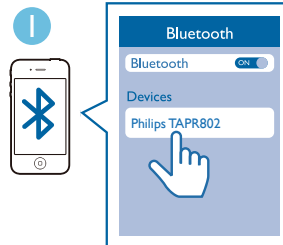
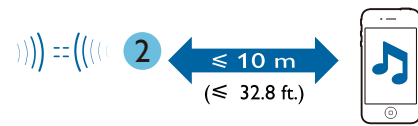
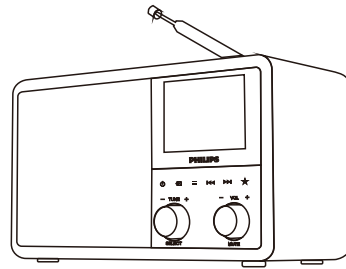



8

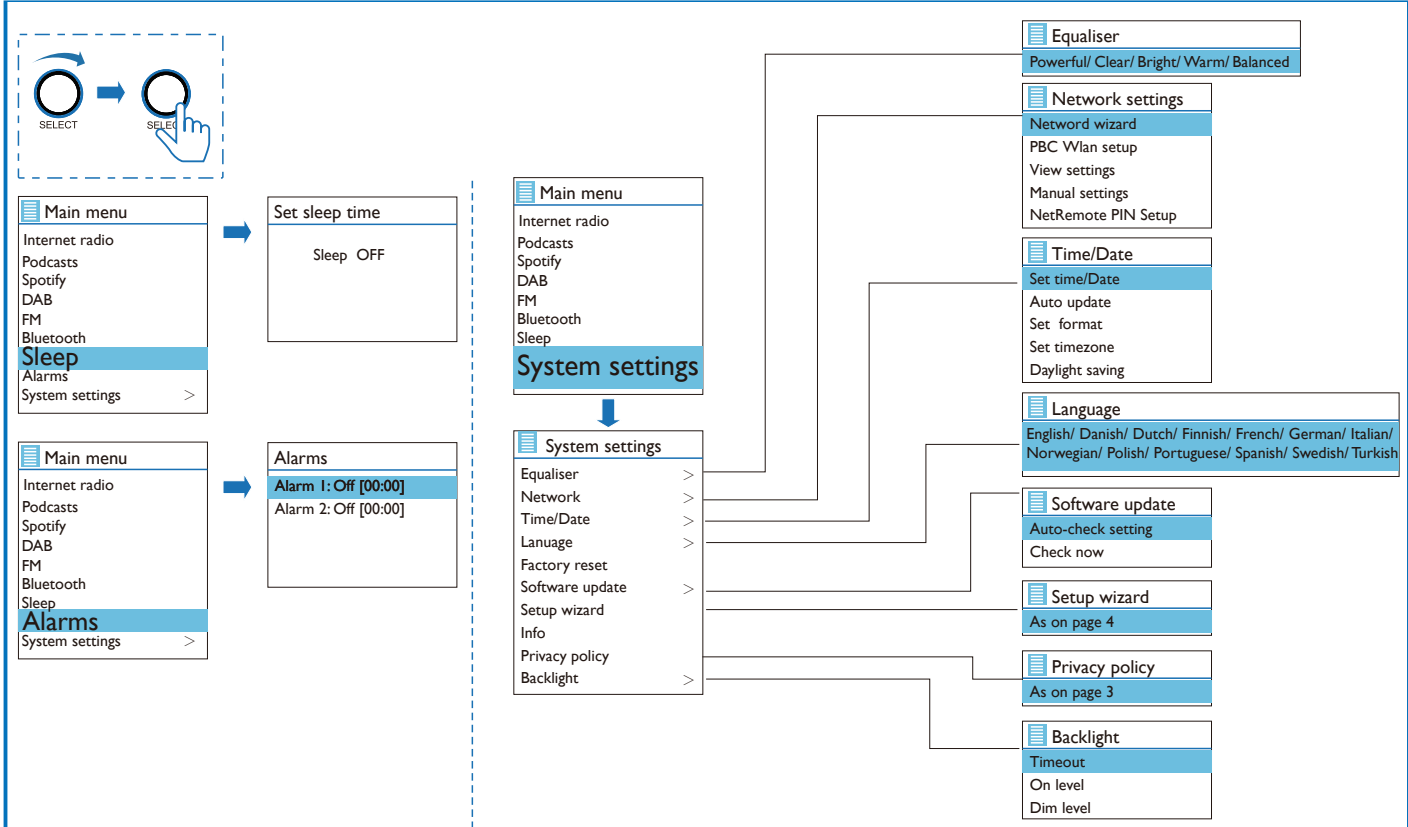



- EN** For more information about using this product, visit www.philips.com/support
- CS** Více informací o použití výrobku naleznete na stránkách www.philips.com/support
- DA** Du kan finde yderligere oplysninger om brugen af dette produkt på www.philips.com/support
- DE** Weitere Informationen zur Verwendung dieses Produkts finden Sie unter www.philips.com/support
- EL** Για περισσότερες πληροφορίες σχετικά με τη χρήση αυτού του προϊόντος, επισκεφθείτε το www.philips.com/support
- ES** Para obtener más información sobre este producto, visite www.philips.com/support
- FI** Lue lisätietoja tuotteen käytöstä osoitteesta www.philips.com/support
- FR** Pour obtenir davantage d'informations sur l'utilisation de ce produit, rendez-vous sur www.philips.com/support

- HU** A termék használatával kapcsolatos további információkkal kapcsolatban tekintse meg a www.philips.com/support weboldalt
- IT** Per ulteriori informazioni sull'uso di questo prodotto, visitare il sito www.philips.com/support
- NL** Ga voor meer informatie over dit product naar www.philips.com/support
- NO** Hvis du vil ha mer informasjon om bruk av dette produktet, kan du gå til www.philips.com/support
- PL** Więcej informacji na temat korzystania z tego produktu można znaleźć na stronie www.philips.com/support
- PT** Para mais informações sobre a utilização deste produto, visite www.philips.com/support
- RO** Pentru informații suplimentare despre utilizarea acestui produs, vizitați www.philips.com/support
- SK** Ďalšie informácie o používaní tohto výrobku nájdete na stránke www.philips.com/support

- SV** Mer information om att använda den här produkten finns på www.philips.com/support
- TR** Bu ürünün kullanımı hakkında daha fazla bilgi için www.philips.com/support adresini ziyaret edin
- RU** Дополнительную информацию об использовании устройства см. на веб-сайте www.philips.com/support
- UK** Докладнішу інформацію про цей виріб шукайте на www.philips.com/support
- KK** Өнімді пайдалану бойынша қосымша ақпаратты алу үшін www.philips.com/support сайтына кіріңіз
- AR** لمزيد من المعلومات حول استخدام هذا المنتج زيارة www.philips.com/support

The Spotify Software is subject to third party licenses found here: www.spotify.com/connect/third-party-licenses.



The Bluetooth® word mark and logos are registered trademarks owned by Bluetooth SIG, Inc.



www.philips.com/support



Philips and the Philips Shield Emblem are registered trademarks of Koninklijke Philips N.V. and are used under license. This product has been manufactured by and is sold under the responsibility of MMD Hong Kong Holding Limited or one of its affiliates, and MMD Hong Kong Holding Limited is the warrantor in relation to this product.

